

FUSE CLIPS

FOR FERRULE FUSES / PC BOARD MOUNT



30A & 60A FERRULE - FUSE CLIPS

Fuse Clips for 30 & 60 Ampere Ferrule-type Fuses

CAT. NO.	FOR FUSE RATING/SIZE			MOUNTING DETAILS	
	VOLTS	AMPS (max)	FERRULE DIA.	HOLE SIZE	SCREW SIZE
C08915P	600	30	13/32"	.72 dia.	#8
C08919P	600	30	13/32"	.196 dia.	#10
C08916P	250	30	9/16"	.172 dia.	#8
C08917P	250	60	13/16"	.22 X .30"	#10
	600	30	13/16"	.22 X .30"	#10
C08918P	600	60	1-1/16"	.22 X .30"	#10

All clips are UL Recognized: Guide IZLT2, File E52283
All clips are tin-plated copper alloy, non-spring reinforced.

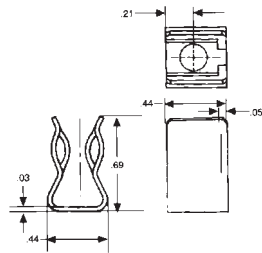

FIGURE 1

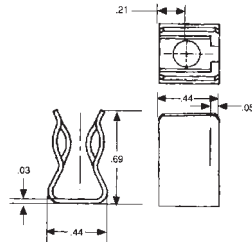

FIGURE 2

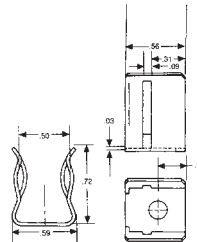

FIGURE 3

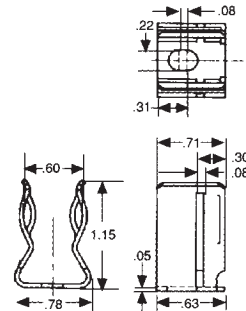

FIGURE 4

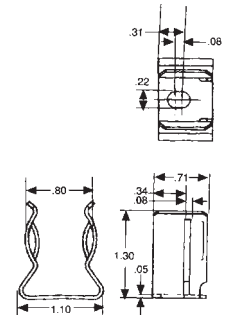
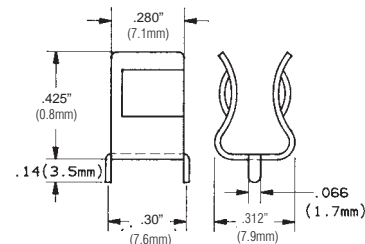

FIGURE 5



SDC6 PC BOARD CLIPS

- PC board mount fuse clip
- For 1/4" diameter fuses
- Tin plated hard brass



SDC5 PC BOARD CLIPS

- PC board mount fuse clip
- For 5mm diameter fuses
- Tin plated hard brass

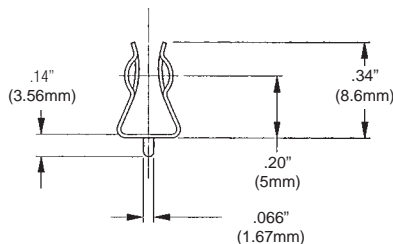

SDC7 PC BOARD CLIPS

- PC board mount fuse clip
- For 13/32" (10mm) diameter fuses
- Tin plated spring brass

